

- (4) Using an ohmmeter, measure the resistance and check the results in accordance with the value(s) in the table below.

Standard Resistance

Tester Connection	Condition	Specified Condition
2 (HR) - 7 (E) 4 (HR) - 8 (B) 3 (VR) - 7 (E) 3 (VR) - 8 (B) 6 (M+) - 7 (E) 6 (M+) - 8 (B)	OFF	10 k Ω or higher
3 (VR) - 8 (B) 6 (M+) - 7 (E)	UP	Below 1 Ω
3 (VR) - 7 (E) 6 (M+) - 8 (B)	DOWN	Below 1 Ω
2 (HR) - 8 (B) 6 (M+) - 7 (E)	LEFT	Below 1 Ω
2 (HR) - 7 (E) 6 (M+) - 8 (B)	RIGHT	Below 1 Ω

If the result is not as specified, replace the outer mirror switch.

INSTALLATION

1. INSTALL OUTER MIRROR SWITCH

- Connect the connector.
- Engage the 2 claws and install the outer mirror switch.

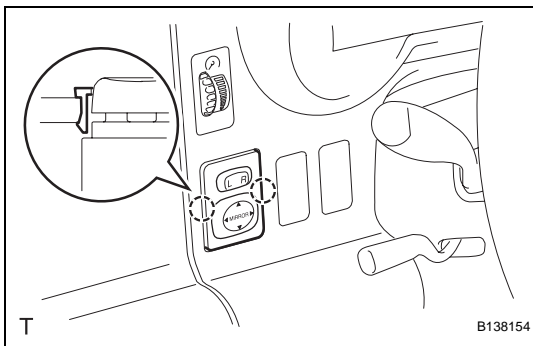

2. INSTALL FUSE BOX OPENING COVER

- Engage the 4 claws and install the fuse box opening cover.

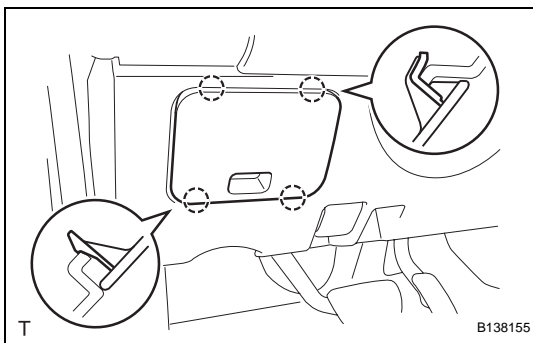

3. CONNECT CABLE TO NEGATIVE BATTERY TERMINAL

Torque: 3.9 N*m (40 kgf*cm, 35 in.*lbf)